TECHNICAL INFORMATION

Series VF-2 VOLUMETRIC FEEDER



The Series VF-2 Volumetric Feeder is used to dispense powder product at a set feed rate. The VF-2 is constructed with type 304 stainless steel product contact material. The VF-2 is designed with a direct drive and small footprint. The VF-2 can be placed directly on top of a 35 gallon tank. It is engineered for reliability with the use of many products.

Alum

Calcium Hydroxide

Calcium Carbonate

Carbon

Copper Sulfate

Diatomaceous Earth

Ferric Sulfate

Polymers

Potassium Permanganate

Sodium Aluminate

Sodium Carbonate

Sodium Fluoride

AUGER  **Feeders, LTD**

325 Westtown Rd., Unit 8 West Chester PA 19382

(610) 692-7290

(610) 692-7282 Fax



FEATURES

RELIABILITY

The VF-2 feeder is designed with a Direct Drive Auger Delivery System. Drive, Auger and Coupling. All of the belts, chains and pulleys have been eliminated in the design. This insures durability and dependability for the rugged environment they are placed.

ACCURACY

With the Direct Drive Auger Delivery System it insures accurate feed rate within 1-2%

CONSTRUCTION

The VF-2 is constructed with type 304 stainless steel. The motor and gear box are manufactured with a corrosion-resistant aluminum alloy housing. NEMA 4/12 controls is available

CAPACITY

The VF-2 comes standard with a 1-1/2 cubic foot hopper.

AUGER AND CONDITIONING

Solid shaft stainless steel auger with numerous configurations to insure the proper feed rate for the application. The feeder comes standard with an overwind to condition the product and insure proper feed. With some products pins are placed on the auger in place of the overwind.

Flexibility

The VF-2 is designed to easily change out the auger and discharge tube when feed rates have changed.



ACCESSORIES

PRODUCT CAPACITY

Auger Feeders offers various sizes of extended hoppers. They are design to bolt to the top of the feeder. Standard extended hoppers are 3-1/2 and 7 cubic foot. Other size extended hoppers can be made to order.

SOLUTION TANKS

The tanks are constructed from type 304 stainless steel. They come in 15 and 50 gallon. Auger feeders also offers a stacker tank in 35 and 65 gallons that the feeder sits on top creating a small foot print. Custom tanks can be made to order. A 5 gallon wetting cone is also offered

LIQUID LEVEL CONTROL

The standard solution tank comes with a brass ball float. An optional conductive level probe can be used sending the information to the control panel.

MIXER

A 1/3 HP mixer motor can be mounted to the top of the solution tank. It comes with a 4" Prop

BAG UNLOADER

A stainless steel bag unloader can be bolted to the top of the feeder. It allows for single bag loading while reducing the airborne debris.

BULK BAG

The feeder can be place below the frame work of a bulk bag unloader. To allow for increase capacity of product storage.

STANDS

Stainless steel stands made from 2" by 2" tubing. Various heights depending on need.



TECHNICAL DATA

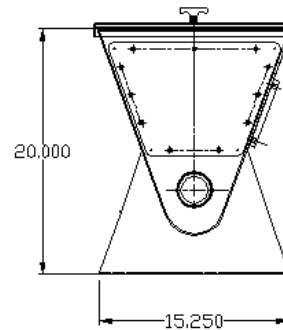
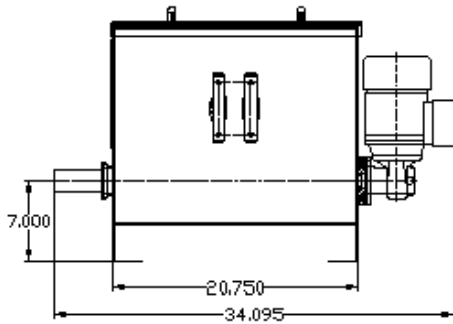

MACHINE SPECIFICATIONS

Floor Dimensions.....	20-3/4 BY 15-1/4 inches
Height.....	20 inches
Hopper Opening.....	15 3/16 by 12 3/8 inches
Feed Rates.....	0.02-11.5 Cubic Feet per Hour
Auger Tooling.....	3/8" to 2" Diameter
Feeder Motor.....	1/2 HP
Electrical Requirements.....	120/240 VAC
Shipping Weight.....	250 Lbs